

REPORT OF GROUP DIRECTOR, NEIGHBOURHOODS AND HOUSING		
<b>LICENSING SUB-COMMITTEE:</b> 10/02/2022	<b>Classification</b> DECISION	<b>Enclosure</b>
<b>Application for a Premises Licence</b>  The Dolphin, 165 Mare Street, London E8 3RH	<b>Ward(s)</b>  <b>affected</b>  London Fields	

## 1. SUMMARY

<b>Applicant(s)</b> Ms Nuvit Yildiz	<b>In SPA:</b> N/A
<b>Date of Application</b> 30/11/2021	<b>Period of Application</b> Permanent
<b>Proposed licensable activity</b>	
Indoor Sporting Events	
Live Music	
Recorded Music	
Performance of dance	
Anything of similar description	
Supply of Alcohol (On Premises)	
<b>Proposed hours of licensable activities</b>	
<b>Indoor Sporting Events</b>	<b>Standard Hours:</b>
	Mon 11:00-23:00
	Tue 11:00-23:00
	Wed 11:00-23:00
	Thu 11:00-23:00
	Fri 11:00-23:00
	Sat 11:00-23:00
	Sun 11:00-23:00
<b>Live Music:</b>	<b>Standard Hours:</b>
	Mon 11:00-23:00
	Tue 11:00-23:00
	Wed 11:00-23:00
	Thu 11:00-23:00
	Fri 11:00-23:00
	Sat 11:00-23:00
	Sun 11:00-23:00
<b>Recorded Music</b>	<b>Standard Hours:</b>
	Mon 11:00-23:00
	Tue 11:00-23:00
	Wed 11:00-23:00

<b>Performance of Dance</b>	Thu 11:00-23:00 Fri 11:00-23:00 Sat 11:00-23:00 Sun 11:00-23:00
	<b>Standard Hours:</b> Mon 11:00-23:00 Tue 11:00-23:00 Wed 11:00-23:00 Thu 11:00-23:00 Fri 11:00-23:00 Sat 11:00-23:00 Sun 11:00-23:00
<b>Other Entertainment Similar to Live or Recorded Music or Dance Performance Premises:</b>	<b>Standard Hours:</b> Mon 11:00-23:00 Tue 11:00-23:00 Wed 11:00-23:00 Thu 11:00-23:00 Fri 11:00-23:00 Sat 11:00-23:00 Sun 11:00-23:00
<b>Supply of Alcohol</b>	<b>Standard Hours:</b> Mon 11:00-01:00 Tue 11:00-01:00 Wed 11:00-01:00 Thu 11:00-01:30 Fri 11:00-03:30 Sat 11:00-03:30 Sun 11:00-01:00

<b>The opening hours of the premises</b>	<b>Standard Hours:</b> Mon 11:00-01:30 Tue 11:00-01:30 Wed 11:00-01:30 Thu 11:00-02:00 Fri 11:00-04:00 Sat 11:00-04:00 Sun 11:00-01:30
<b>Capacity:</b> Not known	
<b>Policies Applicable</b>	LP1 (General Principles), LP2 (Licensing Objectives), LP4 ('Off' Sales of Alcohol) and LP11(Cumulative Impact – General)
<b>List of Appendices</b>	A – Application for a premises licence and supporting documents B – Representations from Responsible Authorities C – Representations from other persons D – Location map

<b>Relevant Representations</b>	<ul style="list-style-type: none"> <li>● Police Authority</li> <li>● Environmental Health Authority (Environmental Protection)</li> <li>● Environmental Health Authority (Environmental Enforcement)</li> <li>● Other Persons</li> </ul>
---------------------------------	------------------------------------------------------------------------------------------------------------------------------------------------------------------------------------------------------------------------------------------

## 2. APPLICATION

2.1 Ms Nuvit Yildizhas made an application for a premises licence under the Licensing Act 2003:

- To authorise the supply alcohol for consumption on the premises
- To provide indoor sporting events
- To provide recorded music
- To provide live music
- To provide performance of dance
- To provide anything of similar description

2.2 The application is attached as Appendix A.

## 3. CURRENT STATUS / HISTORY

3.1 The premises are not currently licensed for any activity.

The premises were previously licensed under the Licensing Act 2003 - Premises Licence LBH-PRE-T-0669 . The premises licence was revoked following an expedited review submitted by the Police Authority on the grounds of prevention of crime and disorder following an incident of serious crime/disorder which occurred on 15 October 2021. A copy of the licence is attached as part of the application "Appendix A"

## 4. REPRESENTATIONS: RESPONSIBLE AUTHORITIES

From	Details
Environmental Health Authority (Environmental Protection) Appendix B2	Representation received on grounds of Prevention of Public Nuisance
Environmental Health Authority (Environmental Enforcement) Appendix B3	Representation received on the ground of Prevention of Public Nuisance
Environmental Health Authority (Health & Safety)	No representation received
Weights and Measures (Trading Standards)	No representation received
Planning Authority	No representation received

Area Child Protection Officer	No representation received
Fire Authority	Have confirmed no representation on this application
Police Appendix B1	Representation received on the grounds of Prevention of Crime and disorder and the Prevention of Public Nuisance
Licensing Authority	No representation received
Health Authority	No representation received

## 5. REPRESENTATIONS: OTHER PERSONS

From	Details
2 representations have been received from and on behalf of local residents.  Appendix C1 and C2	Representation received on the grounds of The Prevention of Crime and Disorder, Public Safety and Prevention of Public Nuisance

## 6. GUIDANCE CONSIDERATIONS

- 6.1 The Licensing Authority is required to have regard to any guidance issued by the Secretary of State under the Licensing Act 2003.

## 7. POLICY CONSIDERATIONS

- 7.1 The Licensing Sub-Committee is required to have regard to the London Borough of Hackney's Statement of Licensing Policy ("the Policy") adopted by the Licensing Authority.
- 7.2 The Policy applies to applications where relevant representations have been made. With regard to this application, policies, LP1 (General Principles), LP2 (Licensing Objectives), LP4 ('Off' Sales of Alcohol) and LP11(Cumulative Impact – General) are relevant.

## 8. OFFICER OBSERVATIONS

- 8.1 If the Sub-Committee is minded to approve the application, the following conditions should be applied to the licence:

### Supply Of Alcohol (On/Both)

1. No supply of alcohol may be made under the premises licence:
  - (a) At a time when there is no designated premises supervisor in respect of the premises licence.
  - (b) At a time when the designated premises supervisor does not hold a personal licence or his personal licence is suspended.

2. Every supply of alcohol under the premises licence must be made or authorised by a person who holds a personal licence.
3. (1) The responsible person must ensure that staff on relevant premises do not carry out, arrange or participate in any irresponsible promotions in relation to the premises.  
(2) In this paragraph, an irresponsible promotion means any one or more of the following activities, or substantially similar activities, carried on for the purpose of encouraging the sale or supply of alcohol for consumption on the premises -
  - (a) games or other activities which require or encourage, or are designed to require or encourage, individuals to;
    - (i) drink a quantity of alcohol within a time limit (other than to drink alcohol sold or supplied on the premises before the cessation of the period in which the responsible person is authorised to sell or supply alcohol), or (ii) drink as much alcohol as possible (whether within a time limit or otherwise);
    - (b) provision of unlimited or unspecified quantities of alcohol free or for a fixed or discounted fee to the public or to a group defined by a particular characteristic in a manner which carries a significant risk of undermining a licensing objective;
    - (c) provision of free or discounted alcohol or any other thing as a prize to encourage or reward the purchase and consumption of alcohol over a period of 24 hours or less in a manner which carries a significant risk of undermining a licensing objective;
    - (d) selling or supplying alcohol in association with promotional posters or flyers on, or in the vicinity of, the premises which can reasonably be considered to condone, encourage or glamorise anti-social behaviour or to refer to the effects of drunkenness in any favourable manner.
    - (e) dispensing alcohol directly by one person into the mouth of another (other than where that other person is unable to drink without assistance by reason of a disability).
4. The responsible person must ensure that free potable water is provided on request to customers where it is reasonably available.
5. 5.1. The premises licence holder or club premises certificate holder must ensure that an age verification policy is adopted in respect of the premises in relation to the sales or supply of alcohol.  
  
5.2 The designated premises supervisor in relation to the premises licences must ensure that the supply of alcohol at the premises is carried on in accordance with the age verification policy.  
  
5.3. The policy must require individuals who appear to the responsible person to be under 18 years of age (or such older age as may be specified in the policy) to produce on request, before being served alcohol, identification bearing their photograph, date of birth and either:-

- A. a holographic mark or
- B. an ultraviolet feature.

6. The responsible person shall ensure that:

a) where any of the following alcoholic drinks is sold or supplied for consumption on the premises (other than alcoholic drinks sold or supplied having been made up in advance ready for sale or supply in a securely closed container) it is available to customers in the following measures:

- beer or cider: 1/2 pint;
- gin, rum, vodka or whisky: 25ml or 35ml; and
- still wine in a glass: 125ml; and

a. these measures are displayed in a menu, price list or other printed material which is available to customers on the premises; and

b. where a customer does not in relation to a sale of alcohol specify the quantity of alcohol to be sold, the customer is made aware that these measures are available.

### **Minimum Drinks Pricing**

7. 7.1 A relevant person shall ensure that no alcohol is sold or supplied for consumption on or off the premises for a price which is less than the permitted price.

7.2 For the purposes of the condition set out in paragraph 7.1 above -

(a) "duty" is to be construed in accordance with the Alcoholic Liquor Duties Act 1979;

(b) "permitted price" is the price found by applying the formula -  $P = D + (D \times V)$  Where -

(i) P is the permitted price,

(ii) D is the amount of duty chargeable in relation to the alcohol as if the duty were charged on the date of the sale or supply of the alcohol, and

(iii) V is the rate of value added tax chargeable in relation to the alcohol as if the value added tax were charged on the date of the sale or supply of the alcohol;

(c) "relevant person" means, in relation to premises in respect of which there is in force a premises licence -

(i) the holder of the premises licence,

(ii) the designated premises supervisor (if any) in respect of such a licence, or

(iii) the personal licence holder who makes or authorises a supply of alcohol under such a licence;

(d) "relevant person" means, in relation to premises in respect of which there is in force a club premises certificate, any member or officer of the club present on the premises in a capacity which enables the member or officer to prevent the supply in question; and

(e) "value added tax" means value added tax charged in accordance with the Value Added Tax Act 1994.

7.3 Where the permitted price given by Paragraph 8.2(b) above would (apart from this paragraph) not be a whole number of pennies, the price given by that sub-paragraph shall be taken to be the price actually given by that sub- paragraph rounded up to the nearest penny.

7.4 (1) Sub-paragraph 7.4(2) below applies where the permitted price given by Paragraph 7.2(b) above on a day (“the first day”) would be different from the permitted price on the next day (“the second day”) as a result of a change to the rate of duty or value added tax.

(2) The permitted price which would apply on the first day applies to sales or supplies of alcohol which take place before the expiry of the period of 14 days beginning on the second day.

### **Mandatory Condition - Door Supervision**

8. Each individual who is to carry out a security activity at the premises must be licensed by the Security Industry Authority.

### **Conditions derived from operating schedule**

9. The premises shall maintain a comprehensive CCTV system as per the minimum requirements of the Metropolitan Police Crime Prevention Officer. All entry and exit points will be covered enabling frontal identification of every person entering in any light condition. The CCTV system shall continually record whilst the premises is open for licensable activities and during all times when customers remain on the premises. All recordings shall be stored for a minimum period of 31 days with date and time stamping. Recordings shall be made available immediately upon the request of the Police or any authorised officer of Hackney Borough Council. A staff member from the premises who is conversant with the operation of the CCTV system shall be on the premises at all times -when the premises are open to the public. This staff member shall be able to show Police or any authorised officer of Hackney Borough Council recent data or footage with the absolute minimum of delay when requested.

10. An incident log shall be kept at the premises, and made available immediately on request to any authorised officer of the Hackney Borough Council or the Police, which will record the following:

- a. all crimes reported to the venue;
- b. any complaints received;
- c. any incidents of disorder;
- d. any faults in the CCTV system or searching equipment or scanning equipment;
- e. any refusal of the sale of alcohol;
- f. any visit by a relevant authority or emergency service.

11. There shall be "CCTV in Operation" signs prominently displayed.

12. All instances of crime or disorder are to be reported by the Designated Premises Supervisor or a responsible member of staff to an agreed police contact point, as agreed with the Police.

13. There shall be no promotional sales of alcohol at the premises.
14. There shall be a minimum of 6 SIA registered door supervisors employed at the public house and restaurant on a Thursday, Friday and Saturday evenings from 2000 hours. Additional SIA registered door supervisors to be employed on an operational risk assessment basis. All door supervisors shall enter their full details in the premises daily register at the commencement of their work. They shall record their full name, home address and contact telephone number, their SIA registration number, and the time they commence and conclude working. If the door supervisor was provided by an agency the name, registered business address and contact telephone number will also be recorded. This register will be made available to police or any authorised officer of Hackney Borough Council immediately upon request.
15. There shall be no glass, drinks or open containers outside the front of the Page 5 of 8 Web Copy Web Copy Web Copy Web Copy premises at any time. Customers shall not be permitted to take glasses, drinks or open containers outside the front of the premises at any time, with the exception of water in plastic vessels.
16. Entry and exit to the premises shall be through the front main entrance directly into the premises and not the access way between the restaurant at 163 Mare Street and the Dolphin Bar at 165 Mare Street, except after 0000hours Sunday to Thursday.
17. Where the sale or supply of alcohol is taking place, employees of the premises must request sight of evidence of the age of any person appearing to be under 25 years of age (Challenge 25). Such evidence may include a driving licence or passport.
18. The premises will also, in cooperation with the police, regularly facilitate a premises drug audit using the ion itemiser or similar device
19. The premises will display prominent signage by every entrance and exit, requesting customers to leave the premises quietly and respect local residents.
20. The premises will display and maintain appropriate signage advising customers of the contact details, including telephone contact numbers, of the Designated Premises Supervisor and the manager of the premises.
21. Refuse, including bottles, shall not be taken outside the premises between the hours of 2000 and 0800.
22. All staff should receive training and have an awareness of the four licensing objectives.
23. All emergency exits will remain clearly marked at all times. Emergency escape routes will be kept free of obstruction at all times.
24. There will be no more than 520 patrons within both premises at any one time
25. The Licensee shall ensure that all staff are fully trained and made aware of the legal requirement of businesses to comply with their duty of care as regards the disposal of waste produced from the business premises. The procedure for handling and preparing for disposal of the waste shall be in writing and displayed in a prominent place where it can be referred to at all times by staff.



26. The Licensee shall ensure that any contract for general and recyclable waste disposal shall be appropriate in size to the amount of waste produced by the business.

27. The licensee shall maintain an adequate supply of waste receptacles provided by his registered waste carrier (refuse sacks or commercial waste bins) in order to ensure all refuse emanating from the business is always presented for collection by his waste carrier and shall not use unidentifiable refuse sacks or any other unidentifiable or unmarked waste receptacles.

28. In order to minimise the amount of time any waste remains on the public highway in readiness for collection, the Licensee will ensure the timeframe within which it may expect its waste carrier to collect is adhered to.

29. The Licensee shall erect a sign asking customers to refrain from littering the public highway outside the premises and will also instruct a member of staff to make regular checks of the area immediately outside and within 10 metres either side of the premises and remove any litter, bottles and glasses emanating from the premises. A final check should be made at close of business.

30. The Licensee shall provide a safe receptacle for cigarette ends to be placed outside for the use of customers, such receptacle being carefully placed so as not to cause an obstruction or trip.

31. The Licensee's premises are situated in an area within which refuse may only be left on the public highway at certain times (time bands). If the Licensee's waste carrier cannot or does not comply by collecting the refuse within an hour after the close of any time band imposed by the waste authority, the Licensee must remove the refuse from the public highway and/or keep it within the premises until such time as his/her waste carrier arrives to collect the refuse.

32. All devices capable of playing music in either premises shall be operated through a sound limiting device. The sound limiting device shall be installed within the premises and set at a level determined by and to the satisfaction of an authorised officer of the Noise Pollution Service to allow no more than background music after 2330 hours. The operational panel of the noise limiter shall be secured to the satisfaction of the officer. The keys securing the device shall be held by the Designated Premises Supervisor or another responsible member of staff, and the device shall not be accessed via any other person. The limiter shall not be altered without prior agreement with the Noise Pollution Service

33. The premises will operate an electronic identification scanning system (e.g. ClubScan) after 2100 hrs for customers entering the premises

34. There shall be at least one male and one female member of staff operating as 'floorwalkers' at the premises on Thursday, Friday and Saturday nights from 2000 hours. The task of the floorwalkers shall be to move around the premises, identifying unattended property and minimising losses and thefts.

35. Door staff shall use "clickers" to monitor capacity at the premises.

36. A free cloakroom service shall be provided, and suitable signage displayed encouraging customers to use it.

37. There will be no more than 150 patrons in the garden area before 0200 hours. There will be no more than 100 patrons in the garden area between 0200 hours and 0300 hours. The garden area is as marked in red on the plan. The garden area is to be empty of patrons from 0300 hours.

38. The Premises Licence will not come into effect until Mr Yasar Yildiz leaves his residential unit above the business as well as Ms Nuvit Yildiz retains the Dolphin Pub by end of Matrimonial Proceedings.

### **Conditions derived from Responsible Authority representations**

39. The Licensee shall ensure that all relevant staff are fully trained and made aware of the legal requirement of businesses to comply with their responsibility as regards the disposal of waste produced from the business premises. The procedure for handling and preparing for disposal of the waste shall be in writing and displayed in a prominent place where it can be referred to at all times by staff.

40. The Licensee shall ensure that any contract for general and recyclable waste disposal shall be appropriate in size to the amount of waste produced by the business. The Licensee shall maintain an adequate supply of waste receptacles provided by his registered waste carrier (refuse sacks or commercial waste bins) in order to ensure all refuse emanating from the business is always presented for collection by his waste carrier and shall not use any plain black or unidentifiable refuse sacks or any other unidentifiable or unmarked waste receptacles.

41. The Licensee's premises are situated in an area within which refuse may only be left on the public highway at certain times (time bands). If the Licensee's waste carrier cannot or does not comply by collecting the refuse within an hour after the close of any time band imposed by the waste authority, the Licensee must remove the refuse from the public highway and/or keep it within the premises until such time as his/her waste carrier arrives to collect the refuse.

42. The Licensee shall instruct members of staff to make regular checks of the area immediately outside the premises and remove any litter, bottles and glasses emanating from the premises. A final check should be made at close of business.

43. The Licensee shall provide a safe receptacle for cigarette ends to be placed outside for the use of customers, such receptacle being carefully placed so as not to cause an obstruction or trip.

44. The current trade waste agreement/duty of care waste transfer document shall be conspicuously displayed and maintained in the window of the premises where it can be conveniently seen and read by persons standing in The Dolphin. This should remain

unobstructed at all times and should clearly identify:-

- the name of the registered waste carrier
- the date of commencement of trade waste contract
- the date of expiry of trade waste contract
- the days and times of collection the type of waste including the European Waste Code

## 10. REASONS FOR OFFICER OBSERVATIONS

10.1 Conditions 9 to 38 are derived from applicants operating schedule. Conditions 40 to 44 have been proposed by the Environmental Enforcement.

## 11. LEGAL COMMENTS

11.1 The Council has a duty as a Licensing Authority under the Licensing Act 2003 to carry out its functions with a view to promoting the following 4 licensing objectives;

- The Prevention of Crime and Disorder
- Public Safety
- Prevention of Public Nuisance
- The Protection of Children from Harm

11.2 It should be noted that each of the licensing objectives have equal importance and are the only grounds upon which a relevant representation can be made and for which an application can be refused or terms and conditions attached to a licence.

## 12. HUMAN RIGHTS ACT 1998 IMPLICATIONS

12.1 There are implications to;

- **Article 6** – Right to a fair hearing
- **Article 14** – Not to discriminate
- Balancing: **Article 1**- Peaceful enjoyment of their possession (i.e. a licence is defined as being a possession) with **Article 8** – Right of Privacy (i.e. respect private & family life) to achieve a proportionate decision having regard to the protection of an individuals rights against the interests of the community at large.

## 13. MEMBERS DECISION MAKING

- A. **Option 1**  
That the application be refused
- B. **Option 2**  
That the application be approved, together with any conditions or restrictions which Members consider necessary for the promotion of the Licensing objectives.

## 14. CONCLUSION

14.1 That Members decide on the application under the Licensing Act 2003.

<b>Group Director, Neighbourhoods and Housing</b>	Ajman Ali
<b>Lead Officer (holder of original copy):</b>	Sanaria Hussain Senior Licensing Officer Licensing Service 1 Hillman Street E8 1DY Telephone: 020 8356 2431

## LIST OF BACKGROUND PAPERS RELATING TO THIS REPORT

The following document(s) has been relied upon in the preparation of the report.

<b>Description of document</b>	<b>Location</b>
The Dolphin 165 Mare Street E8 3RH	Licensing Service 1 Hillman Street London E8 1DY

### **Printed matter**

Licensing Act 2003

LBH Statement of Licensing Policy

# APPENDIX A

**Hackney**  
**LA01**

**Application for a premises licence to be granted under the Licensing Act 2003**

## PLEASE READ THE FOLLOWING INSTRUCTIONS FIRST

Before completing this form please read the guidance notes at the end of the form. If you are completing this form by hand please write legibly in block capitals. In all cases ensure that your answers are inside the boxes and written in black ink. Use additional sheets if necessary.

You may wish to keep a copy of the completed form for your records.

I/We Ms Nuvit Yildiz

*(Insert name(s) of applicant)*

**apply for a premises licence under section 17 of the Licensing Act 2003 for the premises described in Part 1 below (the premises) and I/we are making this application to you as the relevant licensing authority in accordance with section 12 of the Licensing Act 2003**

### Part 1 – Premises details

Postal address of premises or, if none, Ordnance Survey map reference or description The Dolphin 165 Mare Street			
<b>Post town</b>	London	<b>Postcode</b>	E8 3RH

Telephone number at premises (if any)	
Non-domestic rateable value of premises	£23750

### Part 2 - Applicant details

Please state whether you are applying for a premises licence as **appropriate** **Please tick as appropriate**

- a) an individual or individuals \*  please complete section (A)
- b) a person other than an individual \*
- i as a limited company/limited liability partnership  please complete section (B)
  - ii as a partnership (other than limited liability)  please complete section (B)
  - iii as an unincorporated association or  please complete section (B)

- iv other (for example a statutory corporation)  please complete section (B)
- c) a recognised club  please complete section (B)
- d) a charity  please complete section (B)
- e) the proprietor of an educational establishment  please complete section (B)
- f) a health service body  please complete section (B)
- g) a person who is registered under Part 2 of the Care Standards Act 2000 (c14) in respect of an independent hospital in Wales  please complete section (B)
- ga) a person who is registered under Chapter 2 of Part 1 of the Health and Social Care Act 2008 (within the meaning of that Part) in an independent hospital in England  please complete section (B)
- h) the chief officer of police of a police force in England and Wales  please complete section (B)

\* If you are applying as a person described in (a) or (b) please confirm (by ticking yes to one box below):

- I am carrying on or proposing to carry on a business which involves the use of the premises for licensable activities; or
- I am making the application pursuant to a
  - statutory function or
  - a function discharged by virtue of Her Majesty's prerogative

**(A) INDIVIDUAL APPLICANTS** (fill in as applicable)

Mr <input type="checkbox"/>	Mrs <input type="checkbox"/>	Miss <input type="checkbox"/>	Ms <input checked="" type="checkbox"/>	Other Title (for example, Rev)	
<b>Surname</b> Yildiz			<b>First names</b> Nuvit		
<b>Date of birth</b> [REDACTED]		I am 18 years old or over		<input checked="" type="checkbox"/>	Please tick yes
<b>Nationality</b> British					
Current residential address if different from premises address		[REDACTED]			
Post town		[REDACTED]	Postcode		[REDACTED]

Daytime contact telephone number	██████████
E-mail address (optional)	██████████
Where applicable (if demonstrating a right to work via the Home Office online right to work checking service), the 9-digit 'share code' provided to the applicant by that service (please see note 15 for information)	

**SECOND INDIVIDUAL APPLICANT** (if applicable)

Mr <input type="checkbox"/>	Mrs <input type="checkbox"/>	Miss <input type="checkbox"/>	Ms <input type="checkbox"/>	Other Title (for example, Rev)	
Surname			First names		
Date of birth		I am 18 years old or over		<input type="checkbox"/> Please tick yes	
Nationality					
Current postal address if different from premises address					
Post town				Postcode	
Daytime contact telephone number					
E-mail address (optional)					
Where applicable (if demonstrating a right to work via the Home Office online right to work checking service), the 9-digit 'share code' provided to the applicant by that service (please see note 15 for information)					

**(B) OTHER APPLICANTS**

Please provide name and registered address of applicant in full. Where appropriate please give any registered number. In the case of a partnership or other joint venture (other than a body corporate), please give the name and address of each party concerned.

Name
------

Address
Registered number (where applicable)
Description of applicant (for example, partnership, company, unincorporated association etc.)
Telephone number (if any)
E-mail address (optional)

**Part 3 Operating Schedule**

When do you want the premises licence to start? DD MM YYYY

2	9	1	2	2	0	2	1
---	---	---	---	---	---	---	---

If you wish the licence to be valid only for a limited period, when do you want it to end? DD MM YYYY

--	--	--	--	--	--	--	--

Please give a general description of the premises (please read guidance note 1)

Pub

If 5,000 or more people are expected to attend the premises at any one time, please state the number expected to attend.

--



What licensable activities do you intend to carry on from the premises?

(Please see sections 1 and 14 and Schedules 1 and 2 to the Licensing Act 2003)

Provision of regulated entertainment (please read guidance note 2) Please tick all that apply

- a) plays (if ticking yes, fill in box A)
- b) films (if ticking yes, fill in box B)
- c) indoor sporting events (if ticking yes, fill in box C)
- d) boxing or wrestling entertainment (if ticking yes, fill in box D)
- e) live music (if ticking yes, fill in box E)
- f) recorded music (if ticking yes, fill in box F)
- g) performances of dance (if ticking yes, fill in box G)
- h) anything of a similar description to that falling within (e), (f) or (g) (if ticking yes, fill in box H)

**Provision of late night refreshment** (if ticking yes, fill in box I)

**Supply of alcohol** (if ticking yes, fill in box J)

**In all cases complete boxes K, L and M**

**A**

<b>Plays</b> Standard days and timings (please read guidance note 7)			<b>Will the performance of a play take place indoors or outdoors or both – please tick</b> (please read guidance note 3)	Indoors <input type="checkbox"/>
				Outdoors <input type="checkbox"/>
				Both <input type="checkbox"/>
Day	Start	Finish		
Mon			<b>Please give further details here</b> (please read guidance note 4)	
Tue				
Wed			<b>State any seasonal variations for performing plays</b> (please read guidance note 5)	
Thur				
Fri			<b>Non-standard timings. Where you intend to use the premises for the performance of plays at different times to those listed in the column on the left, please list</b> (please read guidance note 6)	
Sat				
Sun				

**C**

<b>Indoor sporting events</b> Standard days and timings (please read guidance note 7)			<b>Please give further details</b> (please read guidance note 4) Pool
Day	Start	Finish	
Mon	11:00	23:00	
Tue	11:00	23:00	<b>State any seasonal variations for indoor sporting events</b> (please read guidance note 5) N/A
Wed	11:00	23:00	
Thur	11:00	23:00	<b>Non-standard timings. Where you intend to use the premises for indoor sporting events at different times to those listed in the column on the left, please list</b> (please read guidance note 6) N/A
Fri	11:00	23:00	
Sat	11:00	23:00	
Sun	11:00	23:00	

## E

<b>Live music</b> Standard days and timings (please read guidance note 7)			<b>Will the performance of live music take place indoors or outdoors or both – please tick</b> (please read guidance note 3)	Indoors	<input checked="" type="checkbox"/>			
				Outdoors	<input type="checkbox"/>			
				Both	<input type="checkbox"/>			
<b>Day</b>	<b>Start</b>	<b>Finish</b>	<b>Please give further details here</b> (please read guidance note 4)					
Mon	11:00	23:00						
Tue	11:00	23:00						
Wed	11:00	23:00				<b>State any seasonal variations for the performance of live music</b> (please read guidance note 5) N/A		
Thur	11:00	23:00						
Fri	11:00	23:00	<b>Non-standard timings. Where you intend to use the premises for the performance of live music at different times to those listed in the column on the left, please list</b> (please read guidance note 6) N/A					
Sat	11:00	23:00						
Sun	11:00	23:00						

**F**

<b>Recorded music</b> Standard days and timings (please read guidance note 7)			<b>Will the playing of recorded music take place indoors or outdoors or both – please tick</b> (please read guidance note 3)	Indoors	<input checked="" type="checkbox"/>
				Outdoors	<input type="checkbox"/>
				Both	<input type="checkbox"/>
<b>Day</b>	<b>Start</b>	<b>Finish</b>	<b>Please give further details here</b> (please read guidance note 4)		
Mon	11:00	23:00			
Tue	11:00	23:00			
Wed	11:00	23:00			
			<b>State any seasonal variations for the playing of recorded music</b> (please read guidance note 5)		
			N/A		
Thur	11:00	23:00			
			<b>Non-standard timings. Where you intend to use the premises for the playing of recorded music at different times to those listed in the column on the left, please list</b> (please read guidance note 6)		
Fri	11:00	23:00	N/A		
Sat	11:00	23:00			
Sun	11:00	23:00			

**G**

<b>Performances of dance</b> Standard days and timings (please read guidance note 7)			<b>Will the performance of dance take place indoors or outdoors or both – please tick</b> (please read guidance note 3)	Indoors	<input checked="" type="checkbox"/>
				Outdoors	<input type="checkbox"/>
				Both	<input type="checkbox"/>
Day	Start	Finish	<b>Please give further details here</b> (please read guidance note 4)		
Mon	11:00	23:00			
			<b>State any seasonal variations for the performance of dance</b> (please read guidance note 5) N/A		
Tue	11:00	23:00			
			<b>Non-standard timings. Where you intend to use the premises for the performance of dance at different times to those listed in the column on the left, please list</b> (please read guidance note 6) N/A		
Wed	11:00	23:00			
			<b>Non-standard timings. Where you intend to use the premises for the performance of dance at different times to those listed in the column on the left, please list</b> (please read guidance note 6) N/A		
Thur	11:00	23:00			
			<b>Non-standard timings. Where you intend to use the premises for the performance of dance at different times to those listed in the column on the left, please list</b> (please read guidance note 6) N/A		
Fri	11:00	23:00			
			<b>Non-standard timings. Where you intend to use the premises for the performance of dance at different times to those listed in the column on the left, please list</b> (please read guidance note 6) N/A		
Sat	11:00	23:00			
			<b>Non-standard timings. Where you intend to use the premises for the performance of dance at different times to those listed in the column on the left, please list</b> (please read guidance note 6) N/A		
Sun	11:00	23:00			

H

<b>Anything of a similar description to that falling within (e), (f) or (g)</b> Standard days and timings (please read guidance note 7)			<b>Please give a description of the type of entertainment you will be providing</b>		
Day	Start	Finish	<b>Will this entertainment take place indoors or outdoors or both – please tick</b> (please read guidance note 3)	Indoors	<input checked="" type="checkbox"/>
Mon	11:00	23:00		Outdoors	<input type="checkbox"/>
				Both	<input type="checkbox"/>
Tue	11:00	23:00	<b>Please give further details here</b> (please read guidance note 4)		
Wed	11:00	23:00			
Thur	11:00	23:00	<b>State any seasonal variations for entertainment of a similar description to that falling within (e), (f) or (g)</b> (please read guidance note 5) N/A		
Fri	11:00	23:00			
Sat	11:00	23:00	<b>Non-standard timings. Where you intend to use the premises for the entertainment of a similar description to that falling within (e), (f) or (g) at different times to those listed in the column on the left, please list</b> (please read guidance note 6) N/A		
Sun	11:00	23:00			

I

<b>Late night refreshment</b> Standard days and timings (please read guidance note 7)			<b>Will the provision of late night refreshment take place indoors or outdoors or both – please tick</b> (please read guidance note 3)	Indoors	<input type="checkbox"/>
				Outdoors	<input type="checkbox"/>
				Both	<input type="checkbox"/>
Day	Start	Finish	<b>Please give further details here</b> (please read guidance note 4)		
Mon					
Tue					
Wed			<b>State any seasonal variations for the provision of late night refreshment</b> (please read guidance note 5)		
Thur					
Fri			<b>Non-standard timings. Where you intend to use the premises for the provision of late night refreshment at different times, to those listed in the column on the left, please list</b> (please read guidance note 6)		
Sat					
Sun					



J

<b>Supply of alcohol</b> Standard days and timings (please read guidance note 7)			<b>Will the supply of alcohol be for consumption – please tick</b> (please read guidance note 8)	On the premises	<input checked="" type="checkbox"/>
				Off the premises	<input type="checkbox"/>
				Both	<input type="checkbox"/>
<b>Day</b>	<b>Start</b>	<b>Finish</b>	<b>State any seasonal variations for the supply of alcohol</b> (please read guidance note 5) N/A		
Mon	11:00	01:00			
Tue	11:00	01:00			
Wed	11:00	01:00			
<b>Thur</b>	11:00	01:30	<b>Non-standard timings. Where you intend to use the premises for the supply of alcohol at different times to those listed in the column on the left, please list</b> (please read guidance note 6) N/A		
<b>Fri</b>	11:00	03:30			
<b>Sat</b>	11:00	03:30			
<b>Sun</b>	11:00	01:00			

**State the name and details of the individual whom you wish to specify on the licence as designated premises supervisor (Please see declaration about the entitlement to work in the checklist at the end of the form):**

<b>Name</b> Ms Nuvit Yildiz	
<b>Date of birth</b> [REDACTED]	
<b>Address</b> [REDACTED]	
<b>Postcode</b>	[REDACTED]
[REDACTED]	
<b>Issuing licensing authority (if known)</b> L. B. of Hackney	

K

**Please highlight any adult entertainment or services, activities, other entertainment or matters ancillary to the use of the premises that may give rise to concern in respect of children (please read guidance note 9).**

N/A

L

<b>Hours premises are open to the public</b> Standard days and timings (please read guidance note 7)			<b>State any seasonal variations</b> (please read guidance note 5) N/A
Day	Start	Finish	
Mon	11:00	01:30	<b>Non-standard timings. Where you intend the premises to be open to the public at different times from those listed in the column on the left, please list</b> (please read guidance note 6) N/A
Tue	11:00	01:30	
Wed	11:00	01:30	
Thur	11:00	02:00	
Fri	11:00	04:00	
Sat	11:00	04:00	
Sun	11:00	01:30	

**M** Describe the steps you intend to take to promote the four licensing objectives:

**a) General – all four licensing objectives (b, c, d and e)** (please read guidance note 10)

Premises Licence conditions listed on Premises Licence Number LBH-PRE-T-0669 are proposed.

As you are aware, Mr. & Mrs. Yildiz have been through a marriage breakdown followed by lengthy legal proceedings which continue to this date, as a result, our client only learnt of the situation regarding the licence once it had been suspended and thereafter revoked, within the matrimonial proceedings.

Following our last hearing on 16 November 2021 we were advised by Mr. Yildiz's legal representatives, within the matrimonial proceedings, that he now consents to our client dealing with matters, including the running of the pub, pending a final hearing. Our client's case within the matrimonial proceedings is that she retains the Dolphin Pub.

Mr. Yasar Yildiz would need to vacate the building. Currently Mr. Yildiz resides in the upper residential parts, accordingly, we have written to his legal representatives and requested he vacates.

To date, he has not agreed and in the event he does not, we have advised our client that she can make an application to the Court seeking an injunction to remove him from the building.

**b) The prevention of crime and disorder**

In addition to the conditions enclosed on Premises Licence number LNH-PRE-T-0669, the applicant, Ms Nuvit Yildiz also offers following condition:

The Premises Licence will not come into effect until Mr Yasar Yildiz leaves his residential unit above the business as well as Ms Nuvit Yildiz retains the Dolphin Pub by end of Matrimonial Proceedings.

**c) Public safety**

Premises Licence conditions listed on Premises Licence Number LBH-PRE-T-0669 are proposed.

**d) The prevention of public nuisance**

Premises Licence conditions listed on Premises Licence Number LBH-PRE-T-0669 are proposed.

**e) The protection of children from harm**

Premises Licence conditions listed on Premises Licence Number LBH-PRE-T-0669 are proposed.

**Checklist:**

**Please tick to indicate agreement**

- I have made or enclosed payment of the fee.
- I have enclosed the plan of the premises.
- I have sent copies of this application and the plan to responsible authorities and others where applicable.
- I have enclosed the consent form completed by the individual I wish to be designated premises supervisor, if applicable.
- I understand that I must now advertise my application.
- I understand that if I do not comply with the above requirements my application will be rejected.
- [Applicable to all individual applicants, including those in a partnership which is not a limited liability partnership, but not companies or limited liability partnerships] I have included documents demonstrating my entitlement to work in the United Kingdom or my share code issued by the Home Office online right to work checking service (please read note 15).

**IT IS AN OFFENCE, UNDER SECTION 158 OF THE LICENSING ACT 2003, TO MAKE A FALSE STATEMENT IN OR IN CONNECTION WITH THIS APPLICATION. THOSE WHO MAKE A FALSE STATEMENT MAY BE LIABLE ON SUMMARY CONVICTION TO A FINE OF ANY AMOUNT.**

**IT IS AN OFFENCE UNDER SECTION 24B OF THE IMMIGRATION ACT 1971 FOR A PERSON TO WORK WHEN THEY KNOW, OR HAVE REASONABLE CAUSE TO BELIEVE, THAT THEY ARE DISQUALIFIED FROM DOING SO BY REASON OF THEIR IMMIGRATION STATUS. THOSE WHO EMPLOY AN ADULT WITHOUT LEAVE OR WHO IS SUBJECT TO CONDITIONS AS TO EMPLOYMENT WILL BE LIABLE TO A CIVIL PENALTY UNDER SECTION 15 OF THE IMMIGRATION, ASYLUM AND NATIONALITY ACT 2006 AND PURSUANT**

**TO SECTION 21 OF THE SAME ACT, WILL BE COMMITTING AN OFFENCE WHERE THEY DO SO IN THE KNOWLEDGE, OR WITH REASONABLE CAUSE TO BELIEVE, THAT THE EMPLOYEE IS DISQUALIFIED.**

**Part 4 – Signatures** (please read guidance note 11)

**Signature of applicant or applicant’s solicitor or other duly authorised agent** (see guidance note 12). **If signing on behalf of the applicant, please state in what capacity.**

<b>Declaration</b>	<ul style="list-style-type: none"><li>• [Applicable to individual applicants only, including those in a partnership which is not a limited liability partnership] I understand I am not entitled to be issued with a licence if I do not have the entitlement to live and work in the UK (or if I am subject to a condition preventing me from doing work relating to the carrying on of a licensable activity) and that my licence will become invalid if I cease to be entitled to live and work in the UK (please read guidance note 15).</li><li>• The DPS named in this application form is entitled to work in the UK (and is not subject to conditions preventing him or her from doing work relating to a licensable activity) and I have seen a copy of his or her proof of entitlement to work, or have conducted an online right to work check using the Home Office right to work checking service which confirmed their right to work (please see note 15)</li></ul>
Signature	
Date	30/11/2021
Capacity	██████████, Licensing Consultant

**For joint applications, signature of 2<sup>nd</sup> applicant or 2<sup>nd</sup> applicant’s solicitor or other authorised agent** (please read guidance note 13). **If signing on behalf of the applicant, please state in what capacity.**

Signature	
Date	
Capacity	

Contact name (where not previously given) and postal address for correspondence associated with this application (please read guidance note 14)			
[REDACTED]			
Post town	London	Postcode	N16 8EL
Telephone number (if any)	[REDACTED]		
If you would prefer us to correspond with you by e-mail, your e-mail address (optional)			
[REDACTED]			

### Notes for Guidance

1. Describe the premises, for example the type of premises, its general situation and layout and any other information which could be relevant to the licensing objectives. Where your application includes off-supplies of alcohol and you intend to provide a place for consumption of these off-supplies, you must include a description of where the place will be and its proximity to the premises.
2. In terms of specific regulated entertainments please note that:
  - Plays: no licence is required for performances between 08:00 and 23.00 on any day, provided that the audience does not exceed 500.
  - Films: no licence is required for 'not-for-profit' film exhibition held in community premises between 08.00 and 23.00 on any day provided that the audience does not exceed 500 and the organiser (a) gets consent to the screening from a person who is responsible for the premises; and (b) ensures that each such screening abides by age classification ratings.
  - Indoor sporting events: no licence is required for performances between 08.00 and 23.00 on any day, provided that the audience does not exceed 1000.
  - Boxing or Wrestling Entertainment: no licence is required for a contest, exhibition or display of Greco-Roman wrestling, or freestyle wrestling between 08.00 and 23.00 on any day, provided that the audience does not exceed 1000. Combined fighting sports – defined as a contest, exhibition or display which combines boxing or wrestling with one or more martial arts – are licensable as a boxing or wrestling entertainment rather than an indoor sporting event.
  - Live music: no licence permission is required for:
    - a performance of unamplified live music between 08.00 and 23.00 on any day, on any premises.
    - a performance of amplified live music between 08.00 and 23.00 on any day on premises authorised to sell alcohol for consumption on those premises, provided that the audience does not exceed 500.
    - a performance of amplified live music between 08.00 and 23.00 on any day, in a workplace that is not licensed to sell alcohol on those premises, provided that the audience does not exceed 500.

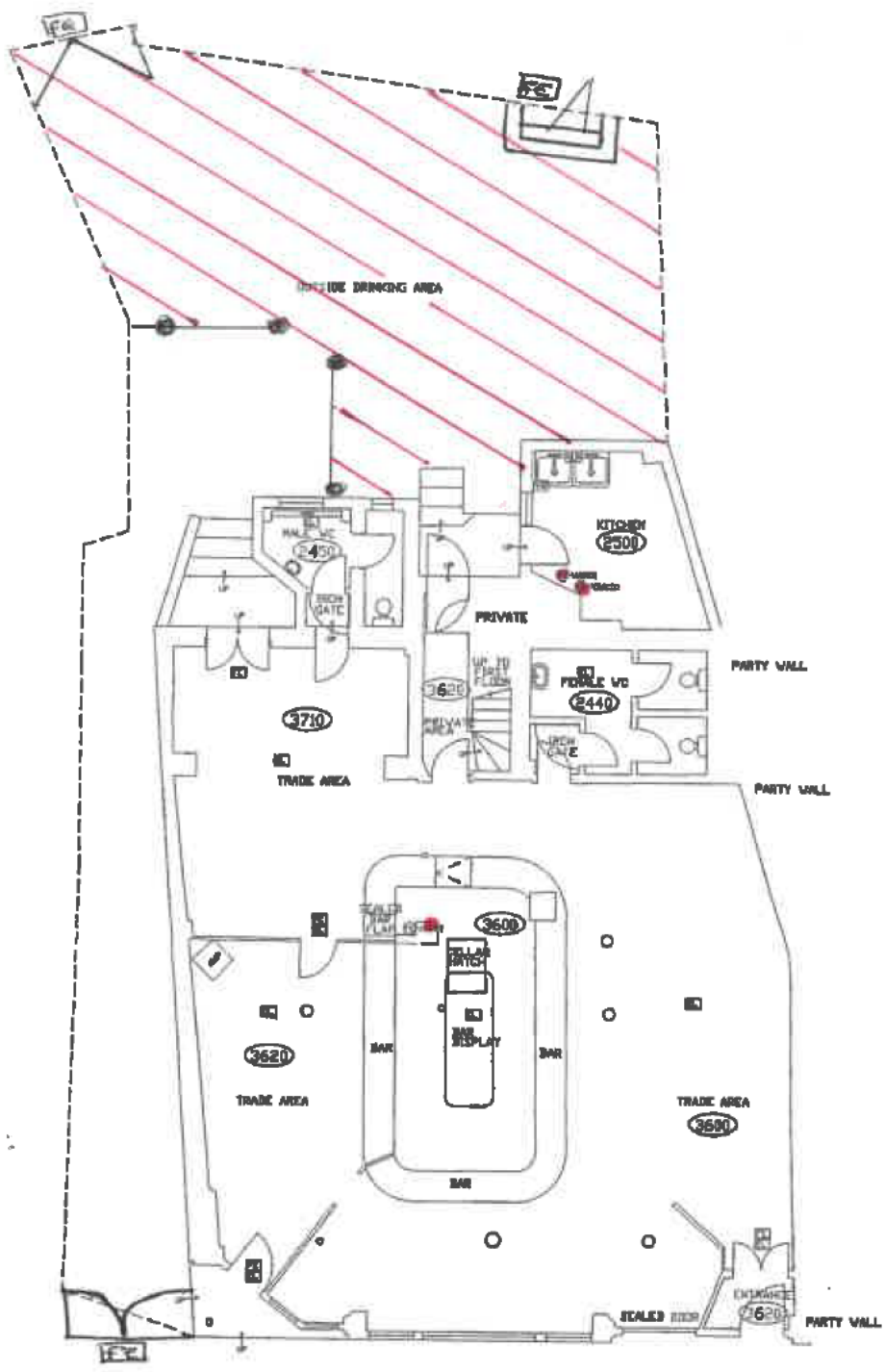

- FE - fire exit.
- EL - Emergency lighting
- - fire extinguisher

BUILDING SURVEYED AREA = 190.2 SQ. M  
 ■ LOCATED AS SURVEYED AND IN CELLAR  
 ■ LOCATED AS SURVEYED  
 SCALE 1:100  
 GROUND FLOOR



**This premises licence has been issued by:**

Licensing Service  
2 Hillman Street  
London E8 1FB

**PART A – PREMISES LICENCE**

**Premises Licence Number**

LBH-PRE-T-0669

**Part 1 – Premises details**

The Dolphin  
165 Mare Street  
London E8 3RH

020 8985 3727

**When the licence is time limited the dates**

Not Applicable

**Licensable activities authorised by the licence**

Indoor Sporting Events  
Live Music  
Recorded Music  
Other Entertainment Similar to Live or Recorded Music or Dance Performance  
Supply of Alcohol

**The times the licence authorises the carrying out of Licensable activities**

**Indoor Sporting Events**

**Standard Hours:**

Mon 11:00-23:30  
Tue 11:00-23:30  
Wed 11:00-23:30  
Thu 11:00-23:30  
Fri 11:00-23:30  
Sat 11:00-23:30  
Sun 11:00-23:30

**Premises:**

**Live Music**

**Standard Hours:**

Mon 11:00-23:30  
Tue 11:00-23:30  
Wed 11:00-23:30  
Thu 11:00-23:30  
Fri 11:00-23:30  
Sat 11:00-23:30  
Sun 11:00-23:30

**Premises:**



**Recorded Music**      **Standard Hours:**  
Mon 11:00-23:30  
**Premises:**      Tue 11:00-23:30  
Wed 11:00-23:30  
Thu 11:00-23:30  
Fri 11:00-23:30  
Sat 11:00-23:30  
Sun 11:00-23:30

**Other**      **Standard Hours:**  
**Entertainment**      Mon 11:00-23:30  
**Similar to Live or**      Tue 11:00-23:30  
**Recorded Music or**      Wed 11:00-23:30  
**Dance**      Thu 11:00-23:30  
**Performance**      Fri 11:00-23:30  
Sat 11:00-23:30  
**Premises:**      Sun 11:00-23:30

**Supply of Alcohol**      **Standard Hours:**  
Mon 11:00-01:00  
**Premises:**      Tue 11:00-01:00  
Wed 11:00-01:00  
Thu 11:00-01:30  
Fri 11:00-03:30  
Sat 11:00-03:30  
Sun 11:00-01:00

**The opening hours of the premises**  
**Premises**      **Standard Hours:**  
Mon 11:00-01:30  
Tue 11:00-01:30  
Wed 11:00-01:30  
Thu 11:00-02:00  
Fri 11:00-04:00  
Sat 11:00-04:00  
Sun 11:00-01:30

**Where the licence authorises supplies of alcohol whether these are on and/or off supplies**

On Premises

copy

Web Copy

**Part 2 –**

**Name, (registered) address telephone number and e-mail (where relevant) of holder of premises licence**

Mr Yasar Yildiz  
The Dolphin  
165 Mare Street  
Hackney  
London  
E8 3RH

Mrs Nuvit Yildiz  
The Dolphin  
165 Mare Street  
Hackney  
London  
E8 3RH

**Registered number of holder, for example company number, charity number (where applicable)**  
N/A

**Name, address and telephone number of designated premises supervisor where the premises authorises the supply of alcohol**

Mr Yasar Yildiz

**Personal licence number and issuing authority of personal licence held by designated premises supervisor where the premises licence authorises the supply of alcohol**

**Date of report:** 24 November 2005

**Signed**

**David Tuitt  
Team Leader - Licensing**

copy

Web Copy

## **Annex 1 - Mandatory Conditions**

### **Supply of Alcohol**

1. No supply of alcohol may be made under the premises licence:
  - (a) At a time when there is no designated premises supervisor in respect of the premises licence.
  - (b) At a time when the designated premises supervisor does not hold a personal licence or his personal licence is suspended.
2. Every supply of alcohol under the premises licence must be made or authorised by a person who holds a personal licence.
3. The responsible person shall take all reasonable steps to ensure that staff on relevant premises do not carry out, arrange or participate in any irresponsible promotions in relation to the premises.
4. The responsible person shall ensure that no alcohol is dispensed directly by one person into the mouth of another (other than where that other person is unable to drink without assistance by reason of a disability).
5. The responsible person shall ensure that free tap water is provided on request to customers where it is reasonably available.
- 6.1. The premises licence holder or club premises certificate holder shall ensure that an age verification policy applies to the premises in relation to the sales or supply of alcohol.
- 6.2. The policy must require individuals who appear to the responsible person to be under 18 years of age (or such older age as may be specified in the policy) to produce on request, before being served alcohol, identification bearing their photograph, date of birth and a holographic mark.
7. The responsible person shall ensure that:
  - a) where any of the following alcoholic drinks is sold or supplied for consumption on the premises (other than alcoholic drinks sold or supplied having been made up in advance ready for sale or supply in a securely closed container) it is available to customers in the following measures:
    - beer or cider: 1/2 pint;
    - gin, rum, vodka or whisky: 25ml or 35ml; and
    - still wine in a glass: 125ml; and
  - b) customers are made aware of the availability of these measures.

### **Door Supervision**

8. Each individual who is to carry out a security activity at the premises must be licensed by the Security Industry Authority.

## **Annex 2 – Conditions consistent with the Operating Schedule**

N/A

## **Annex 3 – Conditions attached after a hearing by the licensing authority**

9. The premises shall maintain a comprehensive CCTV system as per the minimum requirements of the Metropolitan Police Crime Prevention Officer. All entry and exit points will be covered enabling frontal identification of every person entering in any light condition. The CCTV system shall continually record whilst the premises is open for licensable activities and during all times when customers remain on the premises. All recordings shall be stored for a minimum period of 31 days with date and time stamping. Recordings shall be made available immediately upon the request of Police or any authorised officer of Hackney Borough Council. A staff member from the premises who is conversant with the operation of the CCTV system shall be on the premises at all times -when the premises are open to the public. This staff member shall be able to show Police or any authorised officer of Hackney Borough Council recent data or footage with the absolute minimum of delay when requested.

10. An incident log shall be kept at the premises, and made available immediately on request to any authorised officer of the Hackney Borough Council or the Police which will record the following:

- a. all crimes reported to the venue;
- b. any complaints received;
- c. any incidents of disorder;
- d. any faults in the CCTV system or searching equipment or scanning equipment;
- e. any refusal of the sale of alcohol;
- f. any visit by a relevant authority or emergency service.

11. There shall be "CCTV in Operation" signs prominently displayed.

12. All instances of crime or disorder are to be reported by the Designated Premises Supervisor or a responsible member of staff to an agreed police contact point, as agreed with the Police

13. There shall be promotional sales of alcohol at the premises

14. There shall be a minimum of 6 SIA registered door supervisors employed at the public house and restaurant on a Thursday, Friday and Saturday evenings from 2000 hours. Additional SIA registered door supervisors to be employed on an operational risk assessment basis. All door supervisors shall enter their full details in the premises daily register at the commencement of their work. They shall record their full name, home address and contact telephone number, their SIA registration number, and the time they commence and conclude working. If the door supervisor was provided by an agency the name, registered business address and contact telephone number will also be recorded. This register will be made available to police or any authorised officer of Hackney Borough Council immediately upon request.

15 There shall be no glass, drinks or open containers outside the front of the

premises at any time. Customers shall not be permitted to take glasses, drinks or open containers outside the front of the premises at any time, with the exception of water in plastic vessels.

16. Entry and exit to the premises shall be through the front main entrance directly into the premises and not the access way between the restaurant at 163 Mare Street and the Dolphin Bar at 165 Mare Street, except after 0000 hours Sunday to Thursday

17. Where the sale or supply of alcohol is taking place, employees of the premises must request sight of evidence of the age of any person appearing to be under 25 years of age (Challenge 25). Such evidence may include a driving licence or passport.

18. The premises will also, in cooperation with the police, regularly facilitate a premises drug audit using the ion itemiser or similar device

19. The premises will display prominent signage by every entrance and exit, requesting customers to leave the premises quietly and respect local residents.

20. The premises will display and maintain appropriate signage advising customers of the contact details, including telephone contact numbers, of the Designated Premises Supervisor and the manager of the premises.

21. Refuse, including bottles, shall not be taken outside the premises between the hours of 2000 and 0800.

22. All staff should receive training and have an awareness of the four licensing objectives.

23. All emergency exits will remain clearly marked at all times. Emergency escape routes will be kept free of obstruction at all times.

24. There will be no more than 520 patrons within both premises at any one time

25. The Licensee shall ensure that all staff are fully trained and made aware of the legal requirement of businesses to comply with their duty of care as regards the disposal of waste produced from the business premises. The procedure for handling and preparing for disposal of the waste shall be in writing and displayed in a prominent place where it can be referred to at all times by staff.

26. The Licensee shall ensure that any contract for general and recyclable waste disposal shall be appropriate in size to the amount of waste produced by the business.

27. The licensee shall maintain an adequate supply of waste receptacles provided by his registered waste carrier (refuse sacks or commercial waste bins) in order to ensure all refuse emanating from the business is always presented for collection by his waste carrier and shall not use unidentifiable refuse sacks or any other unidentifiable or unmarked waste receptacles

28. In order to minimise the amount of time any waste remains on the public highway in readiness for collection, the Licensee will ensure the timeframe within which it may expect its waste carrier to collect is adhered to.

29. The Licensee shall erect a sign asking customers to refrain from littering the public highway outside the premises and will also instruct a member of staff to make regular checks of the area immediately outside and within 10 metres either side of the premises and remove any litter, bottles and glasses emanating from the premises. A final check should be made at close of business.

30. The Licensee shall provide a safe receptacle for cigarette ends to be placed outside for the use of customers, such receptacle being carefully placed so as not to cause an obstruction or trip.

31. The Licensee's premises are situated in an area within which refuse may only be left on the public highway at certain times (time bands). If the Licensee's waste carrier cannot or does not comply by collecting the refuse within an hour after the close of any time band imposed by the waste authority, the Licensee must remove the refuse from the public highway and/or keep it within the premises until such time as his/her waste carrier arrives to collect the refuse.

32. All devices capable of playing music in either premises shall be operated through a sound limiting device. The sound limiting device shall be installed within the premises and set at a level determined by and to the satisfaction of an authorised officer of the Noise Pollution Service to allow no more than background music after 2330 hours. The operational panel of the noise limiter shall be secured to the satisfaction of the officer. The keys securing the device shall be held by the Designated Premises Supervisor or another responsible member of staff, and the device shall not be accessed via any other person. The limiter shall not be altered without prior agreement with the Noise Pollution Service

33. The premises will operate an electronic identification scanning system (e.g. ClubScan) after 2100 hrs for customers entering the premises.

34. There shall be at least one male and one female member of staff operating as 'floorwalkers' at the premises on Thursday, Friday and Saturday nights from 2000 hours. The task of the floorwalkers shall be to move around the premises identifying unattended property and minimising losses and thefts.

35. Door staff shall use "clickers" to monitor capacity at the premises.

36. A free cloakroom service shall be provided, and suitable signage displayed encouraging customers to use it.

37. There will be no more than 150 patrons in the garden area before 0200 hours. There will be no more than 100 patrons in the garden area between 0200 hours and 0300 hours. The garden area is as marked in red on the plan. The garden area is to be empty of patrons from 0300 hours.

**Annex 4 – Plans**

PLAN/LBH-PRE-T-0669/250705

opy

Web Copy

Our Ref: EP/YIL5278  
Your Ref: Mahir Kilic



6 January 2022



NARTS  
53 Stoke Newington High Street  
London  
N16 8EL

**Only By Email:** [licensing@narts.org.uk](mailto:licensing@narts.org.uk)

Dear Sirs,

**Re: Our Client: Mrs. Nuvit Yildiz  
The Dolphin Public House, 165 Mare Street, Hackney, London, E8 3RH.**

We write to the above and confirm that our client filed for divorce on 14 June 2017, with the petition being issued on 22 June 2017. To date all proceedings have been very acrimonious with multiple applications having been made to the Court by the parties since.

On 17 August 2018 an application was filed on behalf of our client for financial relief. Since this application was made, the case has been heard, together with ancillary applications, on many occasions. In fact, these proceedings are still ongoing.

Since 26 October 2016, and throughout these proceedings, our client has been denied access to the premises and business known as the Dolphin Pub by Mr. Yildiz. This has been documented throughout these proceedings. In addition, Mr. Yildiz has continuously failed to provide our client with information requested pertaining to the business, despite the fact she is a partner of the business and having obtained Court Orders requiring him to do so.

On several occasions, our client has sought an Order to remove Mr. Yildiz from the business, 30 June 2021 being the last time after an application was made to prevent Mr. Yildiz from dissipating assets based on his threat to surrender the leases in respect of the Dolphin Pub. On this date, while DJ Geoff Smith did not at the time Order the removal of Mr. Yildiz, he did Order that our client should be furnished with all the relevant information as per the previous Orders and that Mr. Yildiz was to facilitate access for our client to enter the premises on notice once a month, accompanied by a Solicitor, whereby our client could have access to the stock, the business accounts, the takings, cash register and so on.

Accordingly, our client attended on 28 July 2021 and 19 August 2021, both times accompanied by a member of our firm and a representative from Mr. Yildiz's Solicitors. Mr. Yildiz was not present on either occasion. Both attendances were futile and our client was met with resistance in respect of physical access to parts of the premises, information and equipment.



Arlington Crown Solicitors is the trading name of Arlington Crown Solicitors Limited Registered in England & Wales Company Registration Number 08076344  
A list of Directors is available at our registered office

This Firm is Authorised and Regulated by the Solicitors Regulatory Authority SRA Number 569620  
Please note that this Firm does not accept service by fax or email



In respect of the premises licence, our client only became aware there was an issue on 20 October 2021 when she saw a tweet by Hackney Police advising that the licence had been suspended. We immediately wrote to Mr. Yildiz's Solicitor asking for clarification. On 21 October 2021 they furnished us with a copy of the letter from Hackney Council's licensing services (addressed only to Mr. Yildiz) dated 15 October 2021 advising that the licence had been suspended and why. At the same time, Mr. Yildiz's representatives advised that he had instructed specialist solicitors to deal with the licencing appeal. Despite our requests, we were advised, on 4 November 2021, that the licencing solicitors refused to liaise with us or our client, leaving her without the relevant details, including any deadlines. This was refuted to no avail.

On 15 November 2021 at 16:46, the day before a hearing was listed, we received an email stating that the licence had been permanently revoked. Matters concerning the licence revocation, and the lack of timely disclosure, were raised at a hearing on 16 November 2021. At the hearing Mr. Yildiz informed the Court that he did not have the will to pursue an appeal. DDJ Brett took a dim view of Mr. Yildiz's conduct and ordered that he arrange for his licencing solicitors to disclose the information and documentation needed for an appeal by 30 November 2021. Again, we were met with resistance but eventually we were furnished with some information on 29 November 2021.

We trust the above is of assistance.

Yours faithfully,

  
ARLINGTON CROWN SOLICITORS

# APPENDIX B1

## RESPONSIBLE AUTHORITY REPRESENTATION: APPLICATION UNDER THE LICENSING ACT 2003

### RESPONSIBLE AUTHORITY DETAILS

NAME OF AUTHORITY	Metropolitan Police service
ADDRESS OF AUTHORITY	Licensing Unit, Stoke Police Station 33 Stoke Newington High Street London N16 8DS
CONTACT NAME	PC 3691CE Kerrie RYAN
TELEPHONE NUMBER	07796 183078
E-MAIL ADDRESS	hackneylicensing@met.police.uk

### APPLICATION PREMISES

NAME & ADDRESS OF PREMISES	<b>The Dolphin 165 Mare Street London E8 3RH</b>
NAME OF PREMISES USER	<b>Ms Nuvit YILDIZ</b>

### COMMENTS

I make the following relevant representations in relation to the above application to vary the Premises Licence at the above address.

- 1) the prevention of crime and disorder      ◆
- 2) public safety
- 3) the prevention of public nuisance      ◆
- 4) the protection of children from harm

Representations (which include comments and/or objections) in relation to:

**Police make the following representations in relation to the application for a Premises Licence at THE DOLPHIN, 165 MARE STREET, LONDON, E8 3RH for the following reason(s);**

This is a new application for a Premises Licence at The Dolphin on Mare Street.

On 11<sup>th</sup> November 2021, the licensing sub-committee, sat at a review hearing that had been submitted by police after serious concerns relating to a number of failings by the management in relation to the operation of the premises over an extended period of time and a complete lack of action after a serious assault inside the premises, where a male was glassed in the face by a regular customer. The sub-committee, having considered all of the evidence presented to them by police, decided to revoke all licenses at 163 and 165 Mare Street. 'The sub-committee felt that they were not capable of upholding or promoting the licensing objectives given the issues raised' and 'had no confidence that the Licence holder will comply with conditions on the licence given their history of non-compliance with the licensing objectives'. At the time of the hearing, Ms Nuvit YILDIZ, the applicant in this case, was one of the joint Premises Licence holders. As joint licence holder, Ms YILDIZ, was equally responsible for the failings identified at the hearing and it should be noted that she did not attend the review hearing, despite it being of public record and her having an equal interest in the venue.

Prior to the review hearing, police often visited the premises and spoke with Mr Yasar YILDIZ, he told police that he was going through a divorce and that his wife, Ms Nuvit YILDIZ, was refusing to remove herself from the licence despite her not living or working on or at the premises any longer.

This application seeks an identical licence to the one that existed at 165 Mare Street prior to 10<sup>th</sup> October 2019, when a variation to the licence was granted. This variation brought regulated entertainment in line with the supply of alcohol. This application states that Ms YILDIZ 'learnt of the situation regarding the licence once it had been suspended and thereafter revoked, within the matrimonial proceedings'. Police find it concerning that having learnt of the suspension, which was granted as interim steps at the first expedited review hearing, no attempt was made to contact police, as applicants of the review, nor did she submit any kind of documentation or representation to the council. To date, the first police have heard from Ms YILDIZ is via this application, which has been submitted on her behalf by an agent. No attempt was made to contact police and have a discussion prior to this application being submitted, which would usually happen in cases such as this.

It is also interesting to note that the premises licence was revoked on 11<sup>th</sup> November 2021, and on the 16<sup>th</sup> November 2021, Mr YILDIZ consented to Ms YILDIZ dealing with matters at the pub. And yet knowing of the revocation of the licence did not submit an appeal against the committee's decision within the time frame allowed.

This application is for a new licence at this premises. The hours proposed far exceed the hours stated in LBH's Statement of Licensing Policy in relation to the proposed hours for the sale of alcohol and opening hours.

This premises is on a busy road, but is also opposite and nearby drug and alcohol treatment centres and hostels. There are very often street drinkers outside this premises and other nearby shops and the late hours proposed in this licence and previously held at the venue, will have and had a negative effect on the cumulative impact in the area.

It is also worth noting that during the period of April – October 2021, there were 7 noise complaints received from local residents that were linked to this premises, and police believe that these complaints mainly emanated from the rear garden area and leakage from inside due to doors being left open.

Police believe that the granting of this application would undermine the licensing objectives.

The above representations are supported by the following evidence and information.

Personal knowledge of the local area and previous history of the venue.

Are there any actions or measures that could be taken to allay concerns or objections? If so, please explain.

None

Signed  
PC 3691CE RYAN

(By E-mail)  
Name (printed)



Sanaria Hussain &lt;sanaria.hussain@hackney.gov.uk&gt;

**Premises Licence Application for the Dolphin, 163-165 Mare St**

1 message

**George Wokorach** <george.wokorach@hackney.gov.uk>  
To: Sanaria Hussain <sanaria.hussain@hackney.gov.uk>  
Cc: "Licensing (Shared Mail box)" <licensing@hackney.gov.uk>

29 December 2021 at 22:44

**APPENDIX B2**

Hi Sanaria

Hope you had a Merry Christmas and nice time off during the festive season

The Environmental Protection Team have concerns about noise from loud music and raised voices emanating from the premises.

The team received 9 complaints from 5 different residents between July to October 2021. The Environmental Protection Team witnessed Statutory Nuisance from the premises on 4th September 2021 at 02:00 hours. Approached the premises and brought Mr Yildiz and his wife to the back of the premises and they too witnessed the excessive noise (music and loud conversations) in the street. The officer had a long discussion with both of them regarding the matter and asked them to temporarily reduce the volume of the music and voluntarily reduce the hours of use of the temporary structure, as Best Practicable Means to minimise the noise till such a time when they can carry out sound insulation works to the building. These measures would be temporary and not cost him anything. On this occasion Mr & Mrs Yildiz were made aware that we are receiving complaints about music and raised voices from his premises and asked them to abate the nuisance informally, otherwise a noise abatement notice would be served on the premises if officers witness a further nuisance

Officers again visited the premises on 2 October at 01:49 hours & on 3 October 2021 at 02:30 hours and witnessed excessive and unreasonable noise from music and loud conversations in the street. Following the visits two Noise Abatement Notices were served on Mr & Mrs Yildiz on 29 October 2021.

The notice required them to "at all times control the levels of amplified music and raised voices emitted from the premises so as not to cause nuisance to occupiers of neighbouring dwellings"

The noise abatement notice is still in place and the licence holders have not carried out any works to abate the nuisance or employed Best Practicable Means (BPM) to minimise the noise. The premises are not suitable for containing the type of noise generated within the building and the heavy bass music penetrates the structure and causes disturbance in neighbouring dwellings. Secondly, the light weight structure at the back where customers sit and drink till 4am has no sound insulation and acts as a noise escape route.

However, the applicant has not demonstrated how the premises will control noise from the premises. Therefore the Environmental Protection Team would object to the application and ask the applicant to carry out a noise survey and submit a Noise Impact Report with noise control measures. Without this safeguard in place, the Public Nuisance objective would be compromised.

The applicant is free to contact me with any proposal they have in mind to minimise the noise disturbance to neighbours and uphold the Public Nuisance Objective of the Licensing 2003.

I hope this is useful

Regards

**George Wokorach**  
**Environmental Protection Officer**  
**Projects and Regulatory Services**  
**Neighbourhoods & Housing Directorate**  
**London Borough of Hackney**  
**Hackney Service Centre**  
**2 Hillman Street**  
**London**  
**E8 1FB**

Tel: 0208 356 3403

Email: [George.Wokorach@hackney.gov.uk](mailto:George.Wokorach@hackney.gov.uk)Disclaimers apply, for full details see: <https://hackney.gov.uk/email-disclaimer><https://intranet.hackney.gov.uk/wellbeing-advent-calendar/>

**RESPONSIBLE AUTHORITY REPRESENTATION:  
APPLICATION UNDER THE LICENSING ACT 2003****RESPONSIBLE AUTHORITY DETAILS**

NAME OF AUTHORITY	London Borough of Hackney
ADDRESS OF AUTHORITY	Community Safety & Enforcement Service First Floor Hackney Service Centre 1 Hillman Street London E8 1DY
CONTACT NAME	Jacey Frewin
TELEPHONE NUMBER	020 8356 4567
E-MAIL ADDRESS	jacey.frewin@hackney.gov.uk

**APPLICATION PREMISES**

NAME & ADDRESS OF PREMISES	The Dolphin, 165 Mare Street London E8 3RH
NAME OF APPLICANT	Ms Novit Yildiz

**COMMENTS**

I make the following relevant representations in relation to the above application to vary the Premises Licence at the above address.

- 1) the prevention of crime and disorder •
- 2) public safety •
- 3) the prevention of public nuisance **x**
- 4) the protection of children from harm •

**Representation in relation to:**

## ENVIRONMENTAL LICENCE CONDITIONS IN RESPECT OF

**The Dolphin**  
**165 Mare Street, London E8 3RH**

1. The Licensee shall ensure that all relevant staff are fully trained and made aware of the legal requirement of businesses to comply with their responsibility as regards the disposal of waste produced from the business premises. The procedure for handling and preparing for disposal of the waste shall be in writing and displayed in a prominent place where it can be referred to at all times by staff.
2. The Licensee shall ensure that any contract for general and recyclable waste disposal shall be appropriate in size to the amount of waste produced by the business. The Licensee shall maintain an adequate supply of waste receptacles provided by his registered waste carrier (refuse sacks or commercial waste bins) in order to ensure all refuse emanating from the business is always presented for collection by his waste carrier and shall not use any plain black or unidentifiable refuse sacks or any other unidentifiable or unmarked waste receptacles.
3. The Licensee's premises are situated in an area within which refuse may only be left on the public highway at certain times (time bands). If the Licensee's waste carrier cannot or does not comply by collecting the refuse within an hour after the close of any time band imposed by the waste authority, the Licensee must remove the refuse from the public highway and/or keep it within the premises until such time as his/her waste carrier arrives to collect the refuse.
4. The Licensee shall instruct members of staff to make regular checks of the area immediately outside the premises and remove any litter, bottles and glasses emanating from the premises. A final check should be made at close of business.
5. The Licensee shall provide a safe receptacle for cigarette ends to be placed outside for the use of customers, such receptacle being carefully placed so as not to cause an obstruction or trip.
6. The current trade waste agreement/duty of care waste transfer document shall be conspicuously displayed and maintained in the window of the premises where it can be conveniently seen and read by persons standing in The Dolphin. This should remain unobstructed at all times and should clearly identify:-
  - the name of the registered waste carrier
  - the date of commencement of trade waste contract
  - the date of expiry of trade waste contract
  - the days and times of collection
  - the type of waste including the European Waste Code

The above representations are supported by the following evidence and information.

We have received complaints in the past regarding littering and build-up of waste in the area. There have been instances in the past where Enforcement Officers have found evidence of the illegal disposal of waste from businesses in this area. Experience has also shown that there is the probability that there will be cigarette litter outside these premises due to the smoking ban.

Are there any actions or measures that could be taken to allay concerns or objections? If so, please explain.

contact Jacey Frewin by email

**Name:** Jacey Frewin

**Date:** 10/12/2021





Licensing (Shared Mailbox) <licensing@hackney.gov.uk>

## Licensing application: The Dolphin, 165 Mare Street, Hackney

1 message

24 December 2021 at 13:59

To: "licensing@hackney.gov.uk" <licensing@hackney.gov.uk>, "Emma Plouviez (Cllr)" <emma.plouviez@hackney.gov.uk>

APPENDIX C1

Hi,

I would line to raise my objection to the granting of a license for The Dolphin public House, [165 Mare Street, Hackney](#).

I live on Mentmore Terrace, E83DQ and my flat [redacted] Sidworth Steet and [redacted] The Dolphin. The noise coming from this place is intolerable. I note the application is to play music from 11.00am to 23.00 Monday to Sunday. Every night and especially Friday and Saturday you can hear the loud booming music coming from the venue till well past the 23.00 time of the music licence until 3.30am when it closes. I can feel the vibrations from the very loud bass music reverberating through the flat. Why does no one check that these people are not complying with the terms of their license? It is my understanding after speaking to my local councilor for London Fields, Emma Plouviez, (cc'd) that music from premises should not be audible outside the venue. This is clearly not the case with the Dolphin and it makes sleeping here almost impossible at the weekends. There is also so much noise from their customers who spend the whole evening until 3.30am screaming and shouting outside in their beer garden. The last few weeks since their license was revoked has made living here tolerable again. The place is a total public nuisance and should not be granted a license. If it is, and I've no doubt it will be given a license again, perhaps the council could ensure that it complies with the terms of its license? How often are these places checked for compliance? Can they not be made to fit sound proofing so their music is not audible outside their premises as a condition of their license?

I am very happy to discuss this.

Kind regards,

[redacted] Ment House  
[redacted] [Mentmore Terrace](#)  
[redacted] Hackney  
[redacted]

Get [Outlook for iOS](#)



Licensing (Shared Mailbox) &lt;licensing@hackney.gov.uk&gt;

---

**licensing application The Dolphin - Mare Street**

1 message

24 December 2021 at 15:27

[REDACTED]  
To: licensing@hackney.gov.uk**APPENDIX C2**

Dear Licensing Committee and Officers

I am writing to object to the licensing application from the Dolphin Pub on the grounds of the prevention of crime and disorder and the prevention of public nuisance. I am a local resident on Mentmore terrace, with a property facing towards the back of the Dolphin Pub and its garden.

I appreciate that the Dolphin is a very long established late night venue but the recent involvement of the police in reviewing its licence on the grounds of the prevention of crime and disorder demonstrates that this venue is not an asset to the local community. It's now primarily a destination late night venue which is located in a residential area; albeit on a main road.

From a residential perspective it is a public nuisance at weekends where loud music can be heard which reverberates all round the area. The constant use of the beer garden by large numbers of people shouting and screaming also goes on until 4am when the noise then moves to the streets as people leave the premises. I appreciate that the pub licence pre-dates most of the properties built in the area but the Dolphin does not keep to the terms of music not being heard after 11pm. The music is constant until 4am.

I would be grateful if the Committee could consider the use of the beer garden and the music heard externally when it considers the terms of the licence.

Many thanks,

[REDACTED]  
Ment house, [REDACTED] Mentmore Terrace, E8 [REDACTED][Sent from Yahoo Mail for iPhone](#)

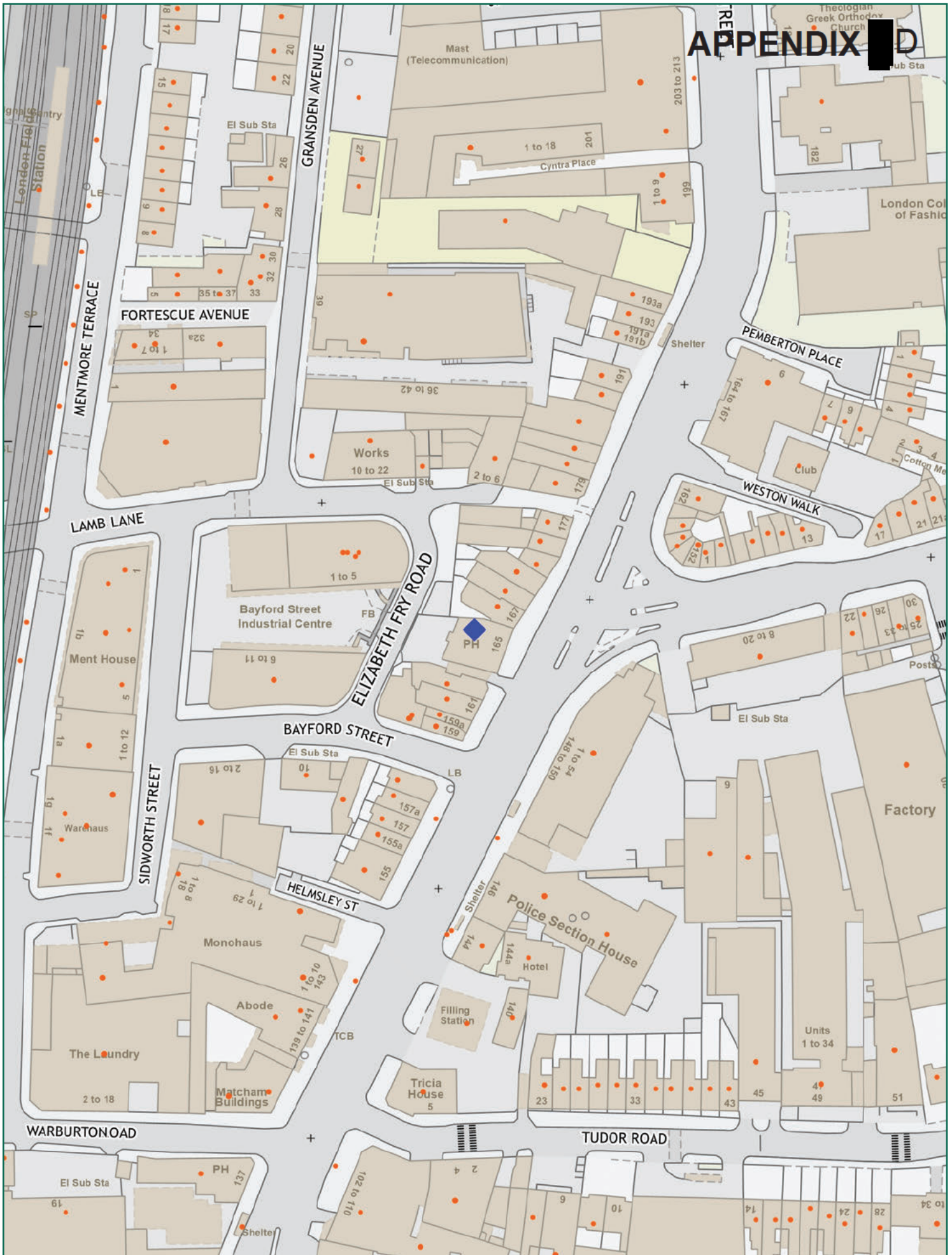

	<h3>The Dolphin, 165 Mare Street, E8 3RH</h3>		
Scale: 1:1250 at A4	Ref:	Produced by: unspecified	please specify copyright statement
	Friday, October 15, 2021	email:	